

Parts list for the SP1 4-gallon Knapsack Sprayer

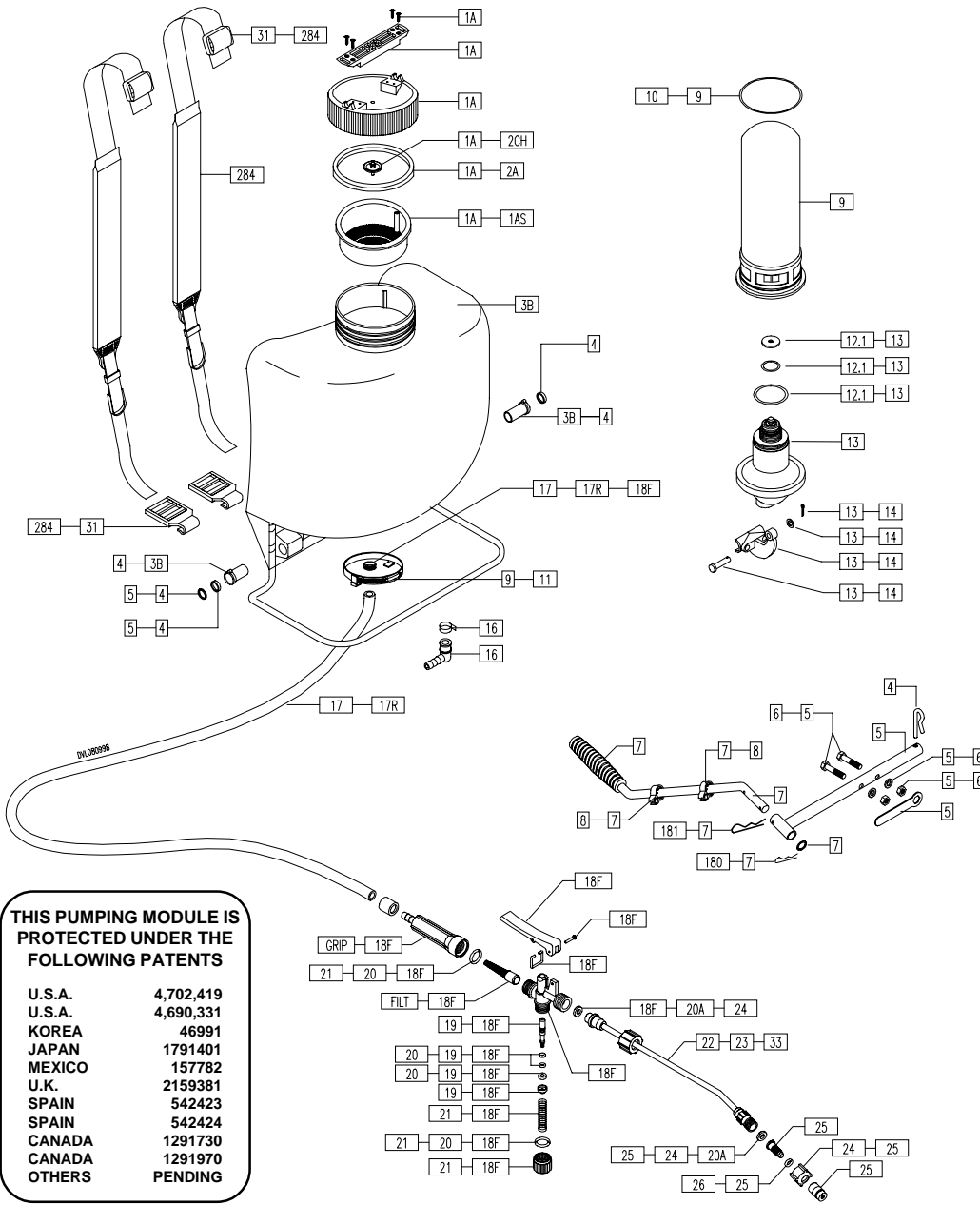

THIS PUMPING MODULE IS PROTECTED UNDER THE FOLLOWING PATENTS

U.S.A.	4,702,419
U.S.A.	4,690,331
KOREA	46991
JAPAN	1791401
MEXICO	157782
U.K.	2159381
SPAIN	542423
SPAIN	542424
CANADA	1291730
CANADA	1291970
OTHERS	PENDING

For your convenience we have three Master Spare Parts Depots, for original SP parts.

WESTHEFFER COMPANY, INC.

Phone: (913) 843-1633 Fax: (913) 843-4486

NORTH AMERICAN WHOLESALE PARTS, INC.

Phone: (800) 286-0679 Fax: (612) 487-3943

JOHN BROOKS COMPANY LIMITED

Toronto Phone: (905) 624-4200 Fax: (905) 624-6379
 Calgary Phone: (403) 291-1180 Fax: (403) 291-0542



PARTS LIST

- Kit 1A Cap w/seal & handle 6".
- Kit 1AS Strainer w/venting hole.
- Kit 2A Seal for cap 6".
- Kit 2CH Check valve for cap.
- Kit 3B Tank w/nylon bearing.
- Kit 4 Nylon bearing.
- Kit 5 Pump lever (fold-back type).
- Kit 6 Screw and nut set.
- Kit 7 Pump handle (fold-back type).
- Kit 8 Plastic clip.
- Kit 9 Pressure tank.
- Kit 10 Pressure tank "O"ring.
- Kit 11 Retention clamp.
- Kit 12.1 Diaphragm "O"ring & washer set.
- Kit 13 Diaphragm pump module.
- Kit 14 Crank.
- Kit 16 90 degree fitting
- Kit 17 Hose set.
- + Kit 17R Hose set (rubber)
- Kit 18F Complete spray pistol w/ built in filter & grip.
- Kit 19 Spindle set.
- Kit 20 Spindle "O"ring set.
- Kit 20A Rubber washer.
- Kit 21 Plug set.
- Kit 22 Brass spray wand.
- + Kit 23 Plastic spray wand.
- Kit 24 Nozzle holder.
- Kit 25 Adjustable brass nozzle with holder.
- Kit 26 Spray tip "O"ring set.
- Kit 31 Belt hooks.
- + Kit 33 Aluminum spray wand
- Kit 180 Locking pin-pump handle (small).
- Kit 181 Locking pin-pump handle (large).
- Kit 284 Padded, adjustable shoulder straps.
- Kit FILT Filter for kit 18F.
- Kit GRIP Grip handle for kit 18F.

NOTE: + Not supplied with unit. See sheet of accessories.

NOTE:

For best results, the sprayer should be pumped every 5 seconds on a continuous basis. This will maintain your spraying pressure. If you do not pump, you will not have pressure to spray



1618 Stanford Street, Suite "C", Santa Monica, CA 90404
 (310) 449-1492 (800) 457-3440 FAX (310) 449-6612

If you have a question or a problem please call us at

1-800-457-3440

We will answer any question you may have.

The SP1 Knapsack Sprayer

We would like to congratulate you on the purchase of your new SP1. The sprayer that allows you the easiest, most comfortable way of carrying out your farm and garden projects with the revolutionary diaphragm pump (patented), that all but eliminates the problems inherent in most sprayers.

As a new owner of the skillfully engineered SP1, we strongly recommend you carefully read and follow all the information on this sheet before use, and then save for future reference.

Please read the attached trouble shooting guide.

HOW TO ASSEMBLE

1. Attach spray wand to spray gun and tighten firmly.
2. Take pump handle Kit 7 (solid) and insert into the tube on the pump lever Kit 5 ("T" shape lever on sprayer), you will notice holes drilled through both sides of both the pump handle and the pump lever. Align these holes, take the "R" pin provided and place through the holes. This affixes the handle in place and is ready for use.
For storage reverse process and then place "R" pin through the pump lever Kit 5 to keep from losing "R" pin.
3. Instructions for installing shoulder strap plastic buckle:
First put the sprayer on a hard flat surface, take the white plastic buckle and while holding the sprayer up slightly, place buckle under the tubular metal frame. Slowly push down forcing the frame into the buckle. Repeat the same procedure for other side.

HOW TO PREPARE YOUR UNIT FOR USE

1. Remove cap.
2. Mix solution in a separate receptacle, following manufacturers directions on the container.
3. Pour pre-mixed solutions into sprayer and cap.
4. Place sprayer on back and pressurize tank by pumping approximately 10 to 15 times. **For best results, the sprayer should be pumped every 5 seconds on a continuous basis. This will maintain your spraying pressure. If you do not pump, you will not have pressure to spray.**
5. Always oil the seal on cap of unit as well as the check valve, this will extend life of seal and is important for obtaining proper seal with no leaks.
6. A unit that has been used with herbicides should never be used to spray insecticides, unless the sprayer has been properly cleaned and all other chemicals neutralized. Failure to do this could cause you to kill plants that have been sprayed. Consult with the manufacturer of the chemicals in use to obtain proper instructions.

HOW TO CLEAN AND MAINTAIN

1. Remove cap and pour out remaining solution, then rinse all parts thoroughly with clean water.
2. Leaving approximately 1/2 gallon of fresh water in tank, pressurize and flush pumping system by depressing trigger at least 2 minutes, then drain all remaining water.
3. Always store tank clean and empty in a dry, shaded location.

CAUTIONS

Failure to follow manufacturers recommendation on use and care of unit will void any expressed or implied warranty.

Do not use chlorine or clorox. It will permanently damage pump system.

Please read and follow all instructions before using sprayer.

- Before using, filling or cleaning any sprayer, read all parts of the operating instructions.
- Make sure to set up the sprayer exactly as explained in the printed operating instructions, reminder tags and/or stickers.
- Wear protective clothing, respirator, gloves, eye protection, etc. whenever using, filling, or cleaning sprayer.
- Periodically re-grease lid gasket as well as lid vent and pump cylinder, where applicable.
- To ensure good performance, keep lid vent free of obstruction. Before and after each use, make sure all connections are well tightened. Service and replace worn parts as required.
- Read and follow all instructions of the chemical suppliers.
- As a rule, mix your chemicals in a separate container from which to fill the sprayer. Do not mix formulas inside the sprayer. Where an exception is made (e.g. with liquid fertilizers), fill sprayer with water BEFORE adding the active ingredient.
- Always sift formula through the screen. If there is no built-in strainer, use a screened funnel.
- Never fill the sprayer with hot liquids. Max. 30°C, or 85°F.
- This sprayer is made to handle agrichemicals in their usual water or oil solutions. Do not use flammable, corrosive or caustic solutions.
- Never use gasoline or other flammable materials.
- Before cleaning or servicing the sprayer, allow all pressure to escape. Do not store or transport sprayer under pressure.
- After each use, wash the sprayer—including hose, lance and shut-off valve—with plenty of fresh water. Unless spraying is to be continued within hours, drain chemical formula and thoroughly rinse the tank and all liquid ducts.
- Never store chemicals in your sprayer for any length of time.
- Use the sprayer only for the kind of jobs for which it was designed. When in doubt, ask your dealer.
- Do not leave the sprayer in reach of children or persons not qualified to handle it in proper fashion.
- When not in use—and especially during prolonged storage—keep your sprayer in a protected place away from direct solar heat.
- Make sure the spray hose loops freely without kinking or squeezing.
- Always use SP Systems original replacement parts.